

# PRODUCT DATA SHEET

## BIMETAL (AL-CU) CABLE LUG



### DESCRIPTION

Bimetal cable lugs are a type of cable lug used to connect aluminum conductors to copper terminals of power cables and electrical equipment in distribution equipment. The aluminum and copper used are electrolytic and the conductivity is very good.

### FEATURES

Material :	99.9% Aluminium and Copper
Tensile Degree :	110MPa
Operating Temperature :	- 40 ° C --- +100 ° C

### MARKINGS



- It complies with CE standards.
- It complies with RoHS standards.
- It complies with ISO 9001 standards.
- It complies with IEC standards.

# PRODUCT DATA SHEET

## BIMETAL (AL-CU) CABLE LUG

### SECTIONS AND DIMENSIONS

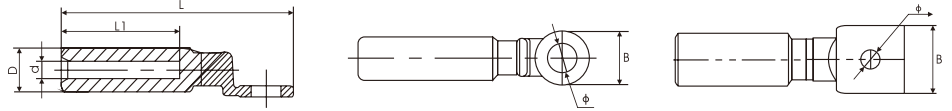

PRODUCT CODE	CABLE SECTION (mm <sup>2</sup> )	BORE DIAMETER Ø	DIMENSIONS				
			d	D	l1	L	B
SKP-BM 16-10	16 mm <sup>2</sup>	M10	6	16	41	82	24
SKP-BM 25-10	25 mm <sup>2</sup>	M10	7	16	41	82	24
SKP-BM 35-10	35 mm <sup>2</sup>	M10	8.5	16	41	82	24
SKP-BM 50-12	50 mm <sup>2</sup>	M12	9.8	20	49	90	25
SKP-BM 70-12	70 mm <sup>2</sup>	M12	11.6	20	49	90	25
SKP-BM 95-12	95 mm <sup>2</sup>	M12	13.8	20	49	90	25
SKP-BM 120-12	120 mm <sup>2</sup>	M12	15.5	25	60	113	28
SKP-BM 150-12	150 mm <sup>2</sup>	M12	17	25	60	113	28
SKP-BM 185-12	185 mm <sup>2</sup>	M12	18.5	32	65	130	35
SKP-BM 240-12	240 mm <sup>2</sup>	M12	21.5	32	65	130	35
SKP-BM 300-12	300 mm <sup>2</sup>	M12	24	34	70,8	135	36
SKP-BM 400-16	400 mm <sup>2</sup>	M16	26	34	70,8	135	36